

Test Fit - Single Tenant

(Creative)

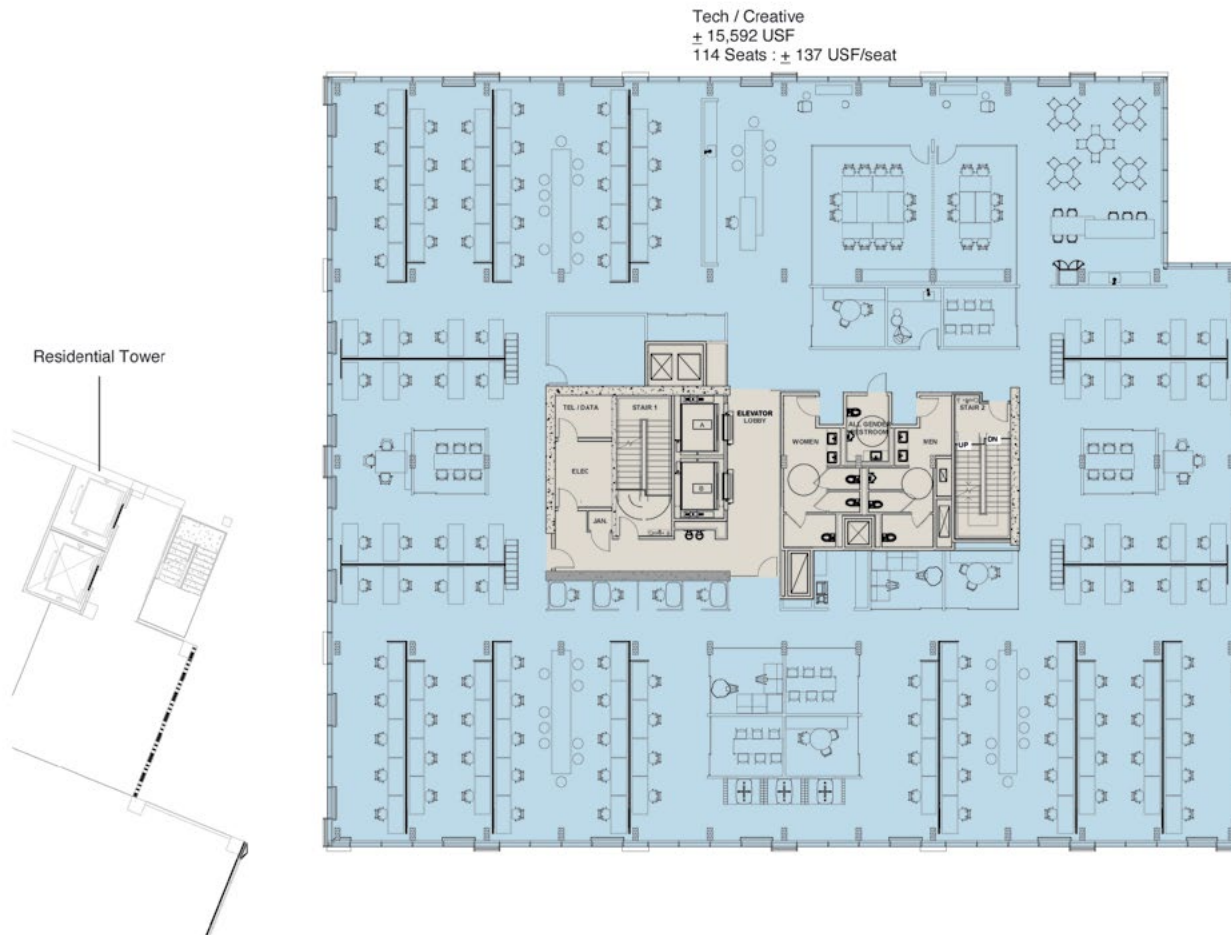

For more information:

GREG LEVI, SIOR

Managing Director

License# 00973235

916.491.4310

Greg.Levi@am.jll.com

ALEXIS GARRETT

Senior Vice President

License# 01836361

916.491.4316

Alexis.Garrett@am.jll.com

Jones Lang LaSalle Brokerage, Inc. Real Estate License #: 01856260

Although information has been obtained from sources deemed reliable, neither Owner nor JLL makes any guarantees, warranties or representations, express or implied, as to the completeness or accuracy as to the information contained herein. Any projections, opinions, assumptions or estimates used are for example only. There may be differences between projected and actual results, and those differences may be material. The Property may be withdrawn without notice. Neither Owner nor JLL accepts any liability for any loss or damage suffered by any party resulting from reliance on this information. If the recipient of this information has signed a confidentiality agreement regarding this matter, this information is subject to the terms of that agreement. ©2022. Jones Lang LaSalle IP, Inc. All rights reserved.

**The outbreak of the COVID-19 virus (novel coronavirus) since the end of January 2020 has resulted in market uncertainty and volatility. While the economic impact of a contagion disease generally arises from the uncertainty and loss of consumer confidence, its impact on real estate values is unknown at this stage.

SOUTHERN LAND
COMPANY



Test Fit - Two Tenant

(Creative/Corporate)

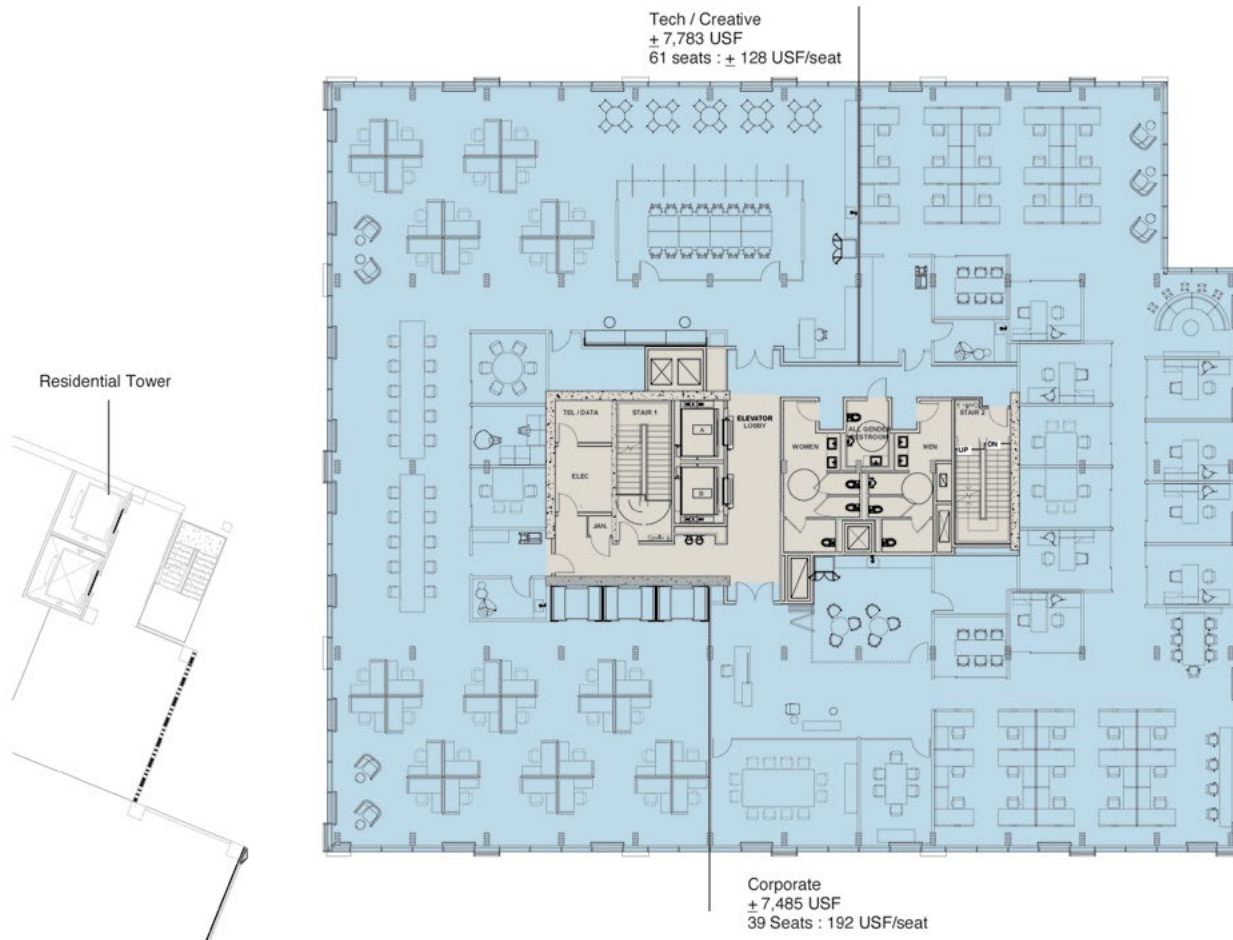

Jones Lang LaSalle Brokerage, Inc. Real Estate License #: 01856260

Although information has been obtained from sources deemed reliable, neither Owner nor JLL makes any guarantees, warranties or representations, express or implied, as to the completeness or accuracy as to the information contained herein. Any projections, opinions, assumptions or estimates used are for example only. There may be differences between projected and actual results, and those differences may be material. The Property may be withdrawn without notice. Neither Owner nor JLL accepts any liability for any loss or damage suffered by any party resulting from reliance on this information. If the recipient of this information has signed a confidentiality agreement regarding this matter, this information is subject to the terms of that agreement. ©2022. Jones Lang LaSalle IP, Inc. All rights reserved.

**The outbreak of the COVID-19 virus (novel coronavirus) since the end of January 2020 has resulted in market uncertainty and volatility. While the economic impact of a contagion disease generally arises from the uncertainty and loss of consumer confidence, its impact on real estate values is unknown at this stage.

For more information:

GREG LEVI, SIOR

Managing Director

License# 00973235

916.491.4310

Greg.Levi@am.jll.com

ALEXIS GARRETT

Senior Vice President

License# 01836361

916.491.4316

Alexis.Garrett@am.jll.com

SOUTHERN LAND
COMPANY



Test Fit - Three Tenant

(Creative/Corp/Professional Services)

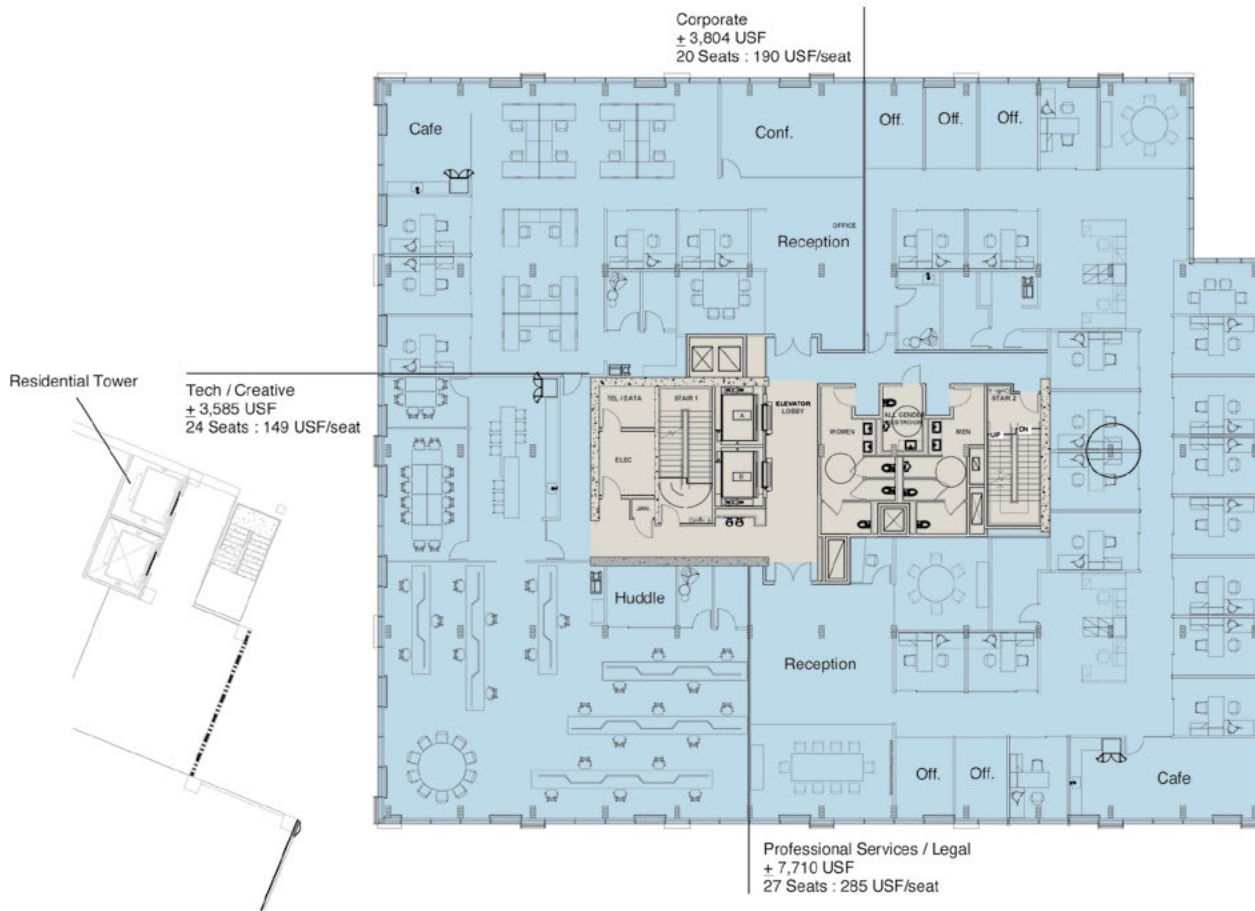

For more information:

GREG LEVI, SIOR

Managing Director

License# 00973235

916.491.4310

Greg.Levi@am.jll.com

ALEXIS GARRETT

Senior Vice President

License# 01836361

916.491.4316

Alexis.Garrett@am.jll.com

Jones Lang LaSalle Brokerage, Inc. Real Estate License #: 01856260

Although information has been obtained from sources deemed reliable, neither Owner nor JLL makes any guarantees, warranties or representations, express or implied, as to the completeness or accuracy as to the information contained herein. Any projections, opinions, assumptions or estimates used are for example only. There may be differences between projected and actual results, and those differences may be material. The Property may be withdrawn without notice. Neither Owner nor JLL accepts any liability for any loss or damage suffered by any party resulting from reliance on this information. If the recipient of this information has signed a confidentiality agreement regarding this matter, this information is subject to the terms of that agreement. ©2022. Jones Lang LaSalle IP, Inc. All rights reserved.

**The outbreak of the COVID-19 virus (novel coronavirus) since the end of January 2020 has resulted in market uncertainty and volatility. While the economic impact of a contagion disease generally arises from the uncertainty and loss of consumer confidence, its impact on real estate values is unknown at this stage.

SOUTHERN LAND
COMPANY

